

ASSEMBLY - VIEW FROM TOP

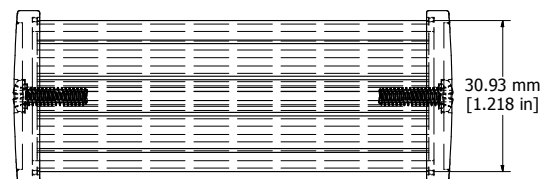

ASSEMBLY - VIEW FROM SIDE

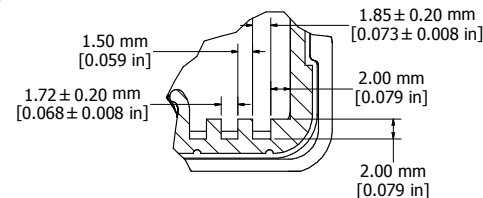
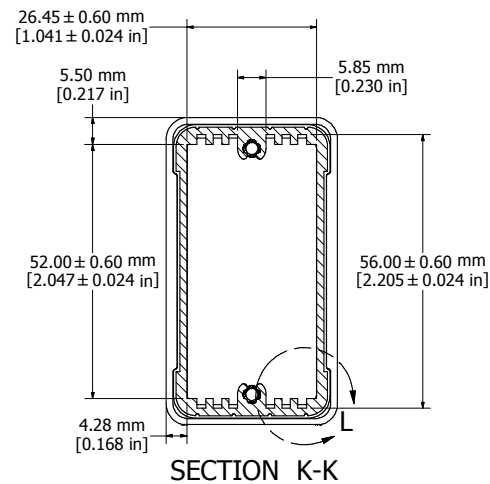

DETAIL L

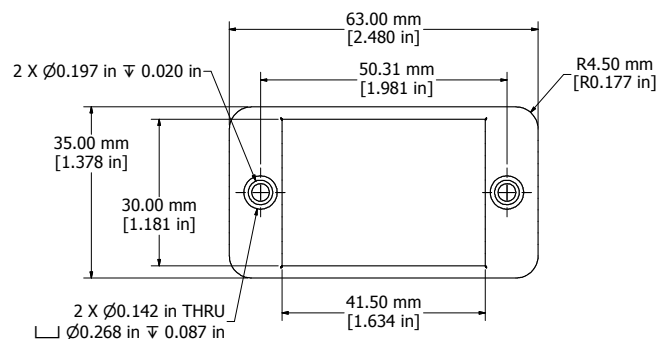

END PANEL - VIEW FROM OUTSIDE

Fits 80mm (3.149") X 55.5mm (2.185") PCB



PROTECTION TO IP 65

Enclosures can be Factory Modified (Milling, Drilling, Printing etc.)
Contact Factory mjm@hammondmfg.com for quotes
Solid models of this enclosure available in STEP or IGES.

NOTE

Purchased assembly includes box, end panels, stainless steel #6 Taptight screws, self adhesive rubber feet, gaskets and O-Rings.

Box made from Extruded Aluminum 6063.

End panels made from Type 380 Diecast Aluminum with a black powder paint finish.

WATERPROOF 1457C801	
PART NUMBERS	
Clear anodized box with black powder painted end panels	1457C801
Black powder painted box and end panels	1457C801BK
EMI/RFI SHIELDED (IP 54)	
Clear anodized box with black powder painted end panels	1457C801E
Black powder painted box and end panels	1457C801EBK
ACCESSORIES	
See website for accessories.	

HAMMOND
MANUFACTURING™

1457C801

www.hammondmfg.com